

Nullifire Technical Drawings

Nullifire FP170 Pipe Collar Pipe Penetrations Through Walls

Table of Contents (1/2)

- ▶ PVC-U pipe penetrating through a flexible or rigid wall construction - pipes Ø40 mm - Ø82 mm (FP170-PS1)
- ▶ PVC-U pipe penetrating through a flexible or rigid wall construction - pipes Ø90 mm - Ø110 mm (FP170-PS2)
- ▶ PVC-U pipe penetrating through a flexible or rigid wall construction - pipes Ø125 mm - Ø160 mm (FP170-PS3)
- ▶ Plastic pipes penetrating through a flexible or rigid wall construction - pipes Ø40 mm - Ø75 mm (FP170-PS4)
- ▶ Plastic pipes penetrating through a flexible or rigid wall construction - pipes Ø90 mm - Ø125 mm (FP170-PS5)
- ▶ Plastic pipes penetrating through a flexible or rigid wall construction - pipes Ø125 mm - Ø160 mm (FP170-PS6)
- ▶ PP-pipe penetrating through a flexible or rigid wall construction - pipes Ø40 mm - Ø110mm (FP170-PS7)
- ▶ PP-pipe penetrating through a flexible or rigid wall construction - pipes Ø140 mm - Ø160mm (FP170-PS8)
- ▶ Plastic pipe penetrating through rigid wall construction - pipes Ø90 mm mm - Ø160 mm (FP170-PS9)
- ▶ Continues on the next page..

Nullifire Technical Drawings

Nullifire FP170 Pipe Collar Pipe Penetrations Through Walls

Table of Contents (2/2)

- ▶ Plastic pipes penetrating through rigid wall construction- pipes Ø125 mm - Ø160 mm (FP170-PS10)
- ▶ BevEx Drinks Python penetrating through a rigid wall construction (FP170-PS11)
- ▶ Steel pipe penetrating through a rigid wall construction pipes Ø47.6 mm / Ø114.3 mm (FP170-PS12)
- ▶ PVC-U pipe penetrating through a flexible or rigid wall construction (FP170-PS13)
- ▶ Plastic pipe penetrating through a rigid wall construction (FP170-PS14)
- ▶ Steel pipe penetrating through a rigid wall construction- pipe Ø219.1 mm (FP170-PS15)

**Nullifire
FP170-PS1**
**Flexible or rigid wall thickness of
min. 100mm or 130mm**

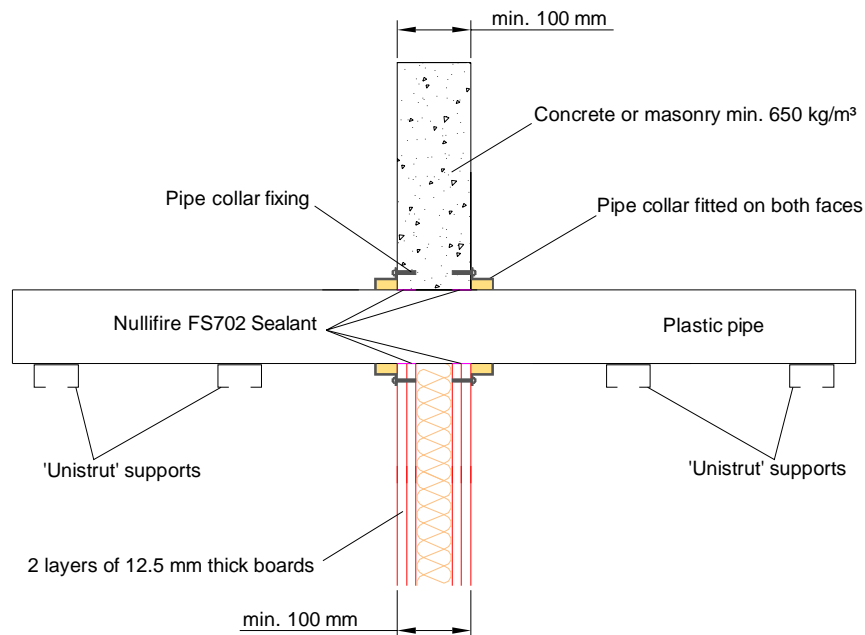

APPROVAL:

ETA 17/0136

**Tested pipe types and max.
Ø of the pipes**
Look at the table in this detail

Nullifire FP170-PS1
Fire class; Look at the table
in this detail

Additional information ETA-
approval/ Annex A.

Technical installation
instructions need to be followed
installing the products.

* PVC-U pipe according to EN
1329-1, EN 1452-2 and EN
1453-1

U/C = (Uncapped/Capped)

Services	Collar Inlay	Fire class
PVC-U* Ø40 mm / 2.4-3.2 mm wall	30 x 6 mm	E120: U/U, C/U, U/C, C/C
PVC-U* Ø55 mm / 2.4-3.2 mm wall		
PVC-U* Ø65 mm / 2.4-3.2 mm wall		
PVC-U* Ø75 mm / 2.4-3.2 mm wall		E160: U/U, C/U, U/C, C/C
PVC-U* Ø82 mm / 2.4-3.2 mm wall		
PVC-U* Ø65 mm / 2.4-3.2^ mm wall		
PVC-U* Ø75 mm / 2.4-3.2^ mm wall		E120: U/U, C/U, U/C, C/C
PVC-U* Ø82 mm / 2.4-3.2^ mm wall		

^only 130mm wall

THE CONTENTS OF THE DRAWING

PVC-U pipe penetrating through a flexible or rigid
wall construction with FP170 pipe collar

DESIGNER

REV

DATE

11.10.2018

SCALE

Not scaled

DETAIL MARK

FP170-PS1

Nullifire has provided this specification on the basis of the data and information given to Nullifire by the customer, the Nullifire product information and level of technical knowledge this specification relates to is expected to provide the level of fire performance, should the proposed detail be subjected to the standardised fire resistance performance against which the judgment has been made.

The accuracy of this specification relies on the following:

1. Only Nullifire products as defined in the specification are used.
2. The specific products are installed by a competent person, utilising Nullifire installation manual and data sheets noting limitations.
3. The proposed specification has been checked by the user.
4. For Details on CE Marked Products Refer to the CE Technical Data Sheets.

SEAL OF APPROVAL MUST BE VERIFIED IF THIS DOCUMENT HAS BEEN MODIFIED

Nullifire

**Nullifire
FP170-PS2**
**Flexible or rigid wall thickness of
min. 100mm or 130mm**

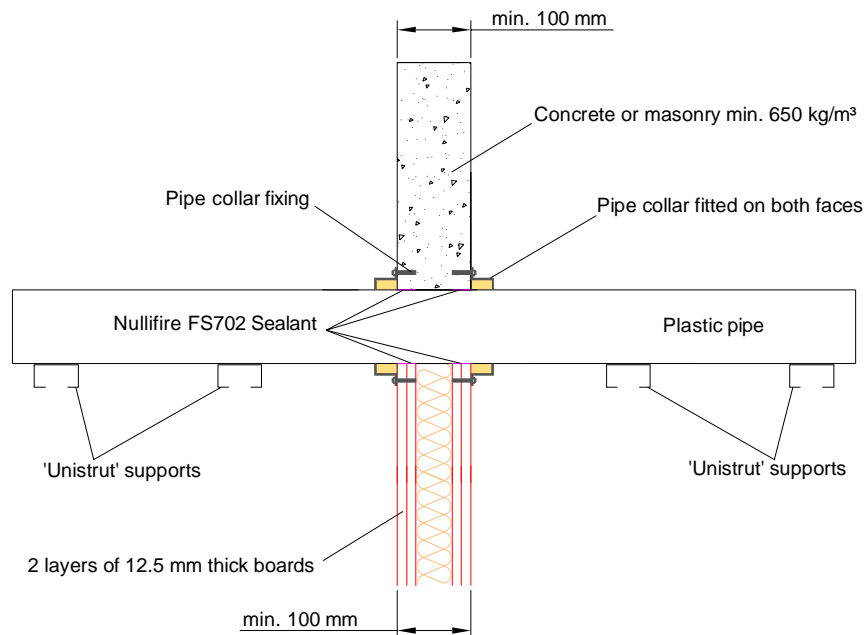

APPROVAL:

ETA 17/0136

**Tested pipe types and max.
Ø of the pipes**
Look at the table in this detail

Nullifire FP170-PS2
Fire class; Look at the table
in this detail

Additional information ETA-
approval/ Annex A.

Technical installation
instructions need to be followed
installing the products.

* PVC-U pipe according to EN
1329-1, EN 1452-2 and EN
1453-1

U/C = (Uncapped/Capped)

Services	Collar Inlay	Fire class
PVC-U* Ø90 mm / 2.7-6.6 mm wall	30 x 10 mm	EI90: U/U, C/U, U/C, C/C
PVC-U* Ø110 mm / 2.7-6.6 mm wall		
PVC-U* Ø90 mm / 6.2 mm wall		EI120: U/U, C/U, U/C, C/C
PVC-U* Ø110 mm / 6.2-9.5 mm wall		

THE CONTENTS OF THE DRAWING

PVC-U pipe penetrating through a flexible or rigid
wall construction with FP170 pipe collar

DESIGNER

REV

DATE

11.10.2018

SCALE

Not scaled

DETAIL MARK

FP170-PS2

Nullifire has provided this specification on the basis of the data and information
given to Nullifire by the customer, the Nullifire product information and level of
technical knowledge this specification relates to is expected to provide the level of
fire performance, should the proposed detail be subjected to the standardised fire
resistance performance against which the judgment has been made.

The accuracy of this specification relies on the following:
1. Only Nullifire products as defined in the specification are used.
2. The specific products are installed by a competent person, utilising Nullifire
installation manual and data sheets noting limitations.
3. The proposed specification has been checked by the user.
4. For Details on CE Marked Products Refer to the CE Technical Data Sheets.

SEAL OF APPROVAL MUST BE VERIFIED IF THIS DOCUMENT HAS BEEN MODIFIED

Nullifire

**Nullifire
FP170-PS3**
**Flexible or rigid wall thickness of
min. 100mm or 130mm**

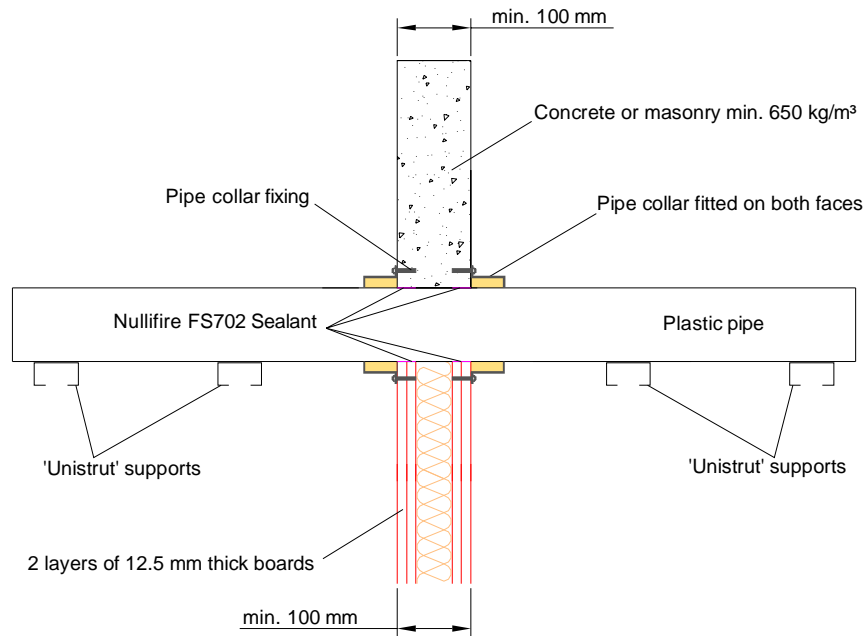

APPROVAL:

ETA 17/0136

**Tested pipe types and max.
Ø of the pipes**
Look at the table in this detail

Nullifire FP170-PS3
Fire class; Look at the table
in this detail

Additional information ETA-
approval/ Annex A.

Technical installation
instructions need to be followed
installing the products.

* PVC-U pipe according to EN
1329-1, EN 1452-2 and EN
1453-1

U/C = (Uncapped/Capped)

^only 130mm wall

Services	Collar Inlay	Fire class
PVC-U* Ø125 mm / 9.5 mm wall	45 x 16 mm	E120: U/U, C/U, U/C, C/C
PVC-U* Ø140 mm / 9.5 mm wall		
PVC-U* Ø160 mm / 9.5 mm wall		
PVC-U* Ø125 mm / 4-9.5 mm wall		E190: U/U, C/U, U/C, C/C
PVC-U* Ø140 mm / 4-9.5 mm wall		
PVC-U* Ø160 mm / 4-9.5 mm wall		
PVC-U* Ø125 mm / 2.5-9.5^ mm wall		E120: U/U, C/U, U/C, C/C
PVC-U* Ø140 mm / 2.5-9.5^ mm wall		
PVC-U* Ø160 mm / 2.5-9.5^ mm wall		

THE CONTENTS OF THE DRAWING

PVC-U pipe penetrating through a flexible or rigid
wall construction with FP170 pipe collar

DESIGNER

REV

DATE

11.10.2018

SCALE

Not scaled

DETAIL MARK

FP170-PS3

Nullifire has provided this specification on the basis of the data and information given to Nullifire by the customer, the Nullifire product information and level of technical knowledge this specification relates to is expected to provide the level of fire performance, should the proposed detail be subjected to the standardised fire resistance performance against which the judgment has been made.

The accuracy of this specification relies on the following:

1. Only Nullifire products as defined in the specification are used.
2. The specific products are installed by a competent person, utilising Nullifire installation manual and data sheets noting limitations.
3. The proposed specification has been checked by the user.
4. For Details on CE Marked Products Refer to the CE Technical Data Sheets.

SEAL OF APPROVAL MUST BE VERIFIED IF THIS DOCUMENT HAS BEEN MODIFIED

Nullifire

**Nullifire
FP170-PS4**
**Flexible or rigid wall thickness of
min. 100mm or 130mm**

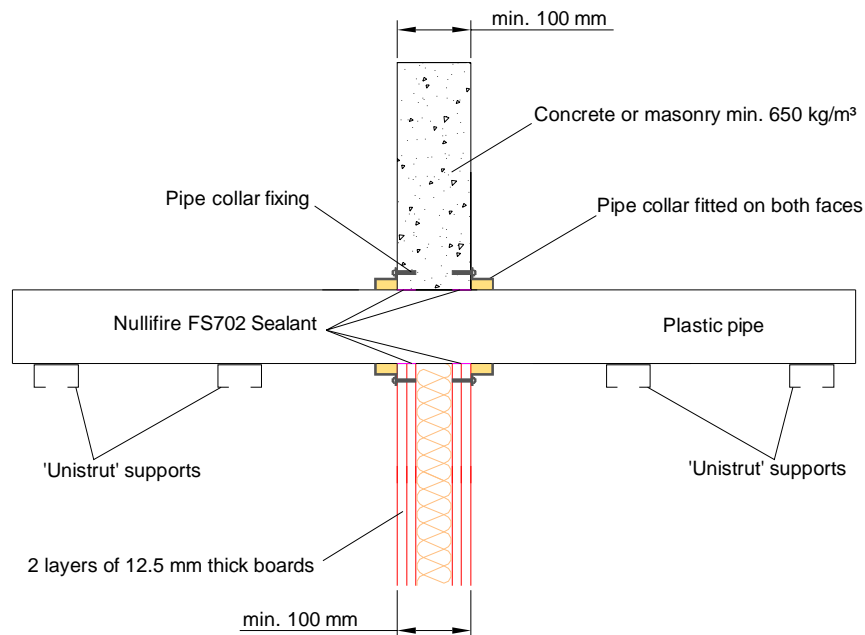

APPROVAL:

ETA 17/0136

**Tested pipe types and max.
Ø of the pipes**
Look at the table in this detail

Nullifire FP170-PS4
**Fire class; Look at the table
in this detail**

Additional information ETA-
approval/ Annex A.

Technical installation
instructions need to be followed
installing the products.

Services: PE, ABS and SAN+PVC

PE pipe according to EN 1519-1,
EN 12201-2 and EN 1266-1,

ABS pipe according to EN 1455-1

SAN+PVC pipe according to EN
1565-1

U/C = (Uncapped/Capped)

Services	Collar Inlay	Fire class
PIPE Ø40 mm / 3.0-4.6 mm wall	30 x 6 mm	EH120: U/U, C/U, U/C, C/C
PIPE Ø50 mm / 3.0-4.6 mm wall		
PIPE Ø75 mm / 4.5-6.8^ mm wall		
PIPE Ø75 mm / 4.5 mm wall		EI90: U/U, C/U, U/C, C/C
PIPE Ø75 mm / 4.5-6.6 mm wall		

THE CONTENTS OF THE DRAWING

Plastic pipes penetrating through a flexible or rigid
wall construction with FP170 pipe collar

DESIGNER

REV

DATE

11.10.2018

SCALE

Not scaled

DETAIL MARK

FP170-PS4

Nullifire has provided this specification on the basis of the data and information given to Nullifire by the customer, the Nullifire product information and level of technical knowledge this specification relates to is expected to provide the level of fire performance, should the proposed detail be subjected to the standardised fire resistance performance against which the judgment has been made.

The accuracy of this specification relies on the following:
1. Only Nullifire products as defined in the specification are used.
2. The specific products are installed by a competent person, utilising Nullifire installation manual and data sheets noting limitations.
3. The proposed specification has been checked by the user.
4. For Details on CE Marked Products Refer to the CE Technical Data Sheets.

SEAL OF APPROVAL MUST BE VERIFIED IF THIS DOCUMENT HAS BEEN MODIFIED

Nullifire

**Nullifire
FP170-PS5**
**Flexible or rigid wall thickness of
min. 100mm or 130mm**

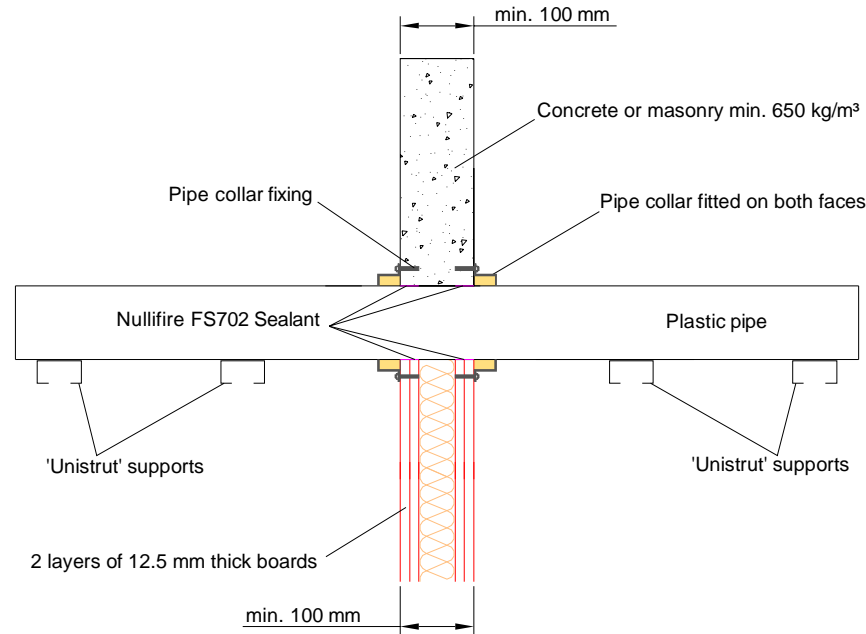

APPROVAL:

ETA 17/0136

**Tested pipe types and max.
Ø of the pipes**
Look at the table in this detail

Nullifire FP170-PS5
**Fire class; Look at the table
in this detail**

Additional information ETA-
approval/ Annex A.

Technical installation
instructions need to be followed
installing the products.

Services: PE, ABS and SAN+PVC

PE pipe according to EN 1519-1,
EN 12201-2 and EN 1266-1,

ABS pipe according to EN 1455-1

SAN+PVC pipe according to EN
1565-1

U/C = (Uncapped/Capped)

Services	Collar Inlay	Fire class
PIPE Ø90 mm / 2.7 mm [^] wall	30 x 10 mm	EI120: U/U, C/U, U/C, C/C
PIPE Ø90 mm / 2.7-6.6 mm wall		EI90: U/U, C/U, U/C, C/C
PIPE Ø90 mm / 10 mm [^] wall		EI120: U/U, C/U, U/C, C/C
PIPE Ø110 mm / 2.7 mm [^] wall		
PIPE Ø110 mm / 2.7-6.6 mm wall		
PIPE Ø110 mm / 10 mm [^] wall		EI90: U/U, C/U, U/C, C/C
PIPE Ø125 mm / 4.8 mm wall		

[^]only 130mm wall

THE CONTENTS OF THE DRAWING

Plastic pipes penetrating through a flexible or rigid
wall construction with FP170 pipe collar

DESIGNER

REV

Nullifire has provided this specification on the basis of the data and information given to Nullifire by the customer, the Nullifire product information and level of technical knowledge this specification relates to is expected to provide the level of fire performance, should the proposed detail be subjected to the standardised fire resistance performance against which the judgment has been made.

The accuracy of this specification relies on the following:
1. Only Nullifire products as defined in the specification are used.
2. The specific products are installed by a competent person, utilising Nullifire installation manual and data sheets noting limitations.
3. The proposed specification has been checked by the user.
4. For Details on CE Marked Products Refer to the CE Technical Data Sheets.

SEAL OF APPROVAL MUST BE VERIFIED IF THIS DOCUMENT HAS BEEN MODIFIED

DATE

11.10.2018

SCALE

Not scaled

DETAIL MARK

FP170-PS5

Nullifire

**Nullifire
FP170-PS6**
**Flexible or rigid wall thickness of
min. 100mm or 130mm**

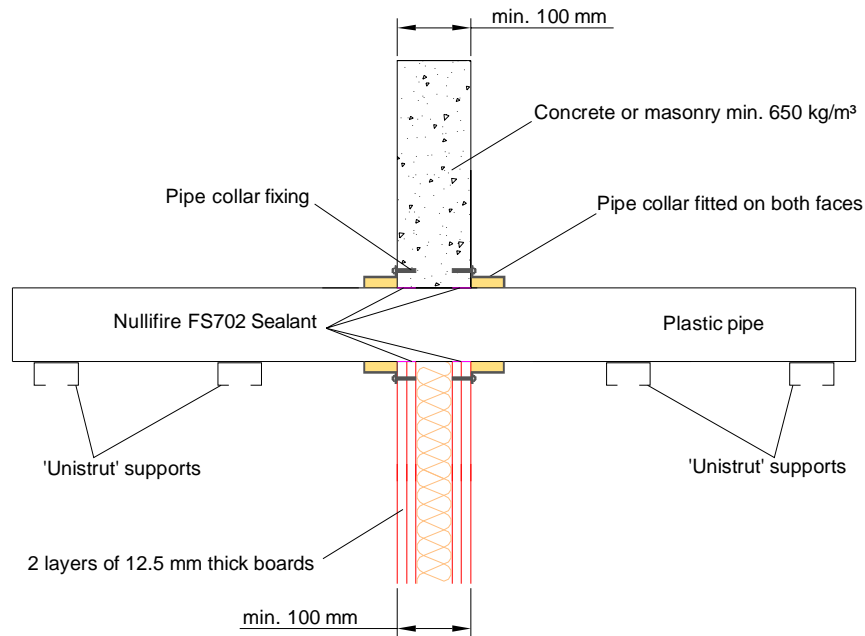

APPROVAL:

ETA 17/0136

**Tested pipe types and max.
Ø of the pipes**
Look at the table in this detail

Nullifire FP170-PS6
Fire class; Look at the table
in this detail

Additional information ETA-
approval/ Annex A.

Technical installation
instructions need to be followed
installing the products.

Services: PE, ABS and SAN+PVC

PE pipe according to EN 1519-1,
EN 12201-2 and EN 1266-1,

ABS pipe according to EN 1455-1

SAN+PVC pipe according to EN
1565-1

U/C = (Uncapped/Capped)

Services	Collar Inlay	Fire class
PIPE Ø125 mm / 4.9-14.6 mm wall	45 x 16 mm	EI60: U/U, C/U, U/C, C/C
PIPE Ø125 mm / 9.5 mm^ wall		EI120: U/U, C/U, U/C, C/C
PIPE Ø140 mm / 14.6 mm wall		EI60: U/U, C/U, U/C, C/C
PIPE Ø140 mm / 9.5 mm^ wall		EI120: U/U, C/U, U/C, C/C
PIPE Ø160 mm / 14.6 mm wall		EI60: U/U, C/U, U/C, C/C
PIPE Ø160 mm / 9.5 mm^ wall		EI120: U/U, C/U, U/C, C/C

^only 130mm wall

THE CONTENTS OF THE DRAWING

Plastic pipes penetrating through a flexible or rigid
wall construction with FP170 pipe collar

DESIGNER

REV

Nullifire has provided this specification on the basis of the data and information given to Nullifire by the customer, the Nullifire product information and level of technical knowledge this specification relates to is expected to provide the level of fire performance, should the proposed detail be subjected to the standardised fire resistance performance against which the judgment has been made.

The accuracy of this specification relies on the following:
1. Only Nullifire products as defined in the specification are used.
2. The specific products are installed by a competent person, utilising Nullifire installation manual and data sheets noting limitations.
3. The proposed specification has been checked by the user.
4. For Details on CE Marked Products Refer to the CE Technical Data Sheets.

SEAL OF APPROVAL MUST BE VERIFIED IF THIS DOCUMENT HAS BEEN MODIFIED

DATE

11.10.2018

SCALE

Not scaled

DETAIL MARK

FP170-PS6

Nullifire

Nullifire
FP170-PS7
Flexible or rigid wall thickness of
min. 100mm or 130mm

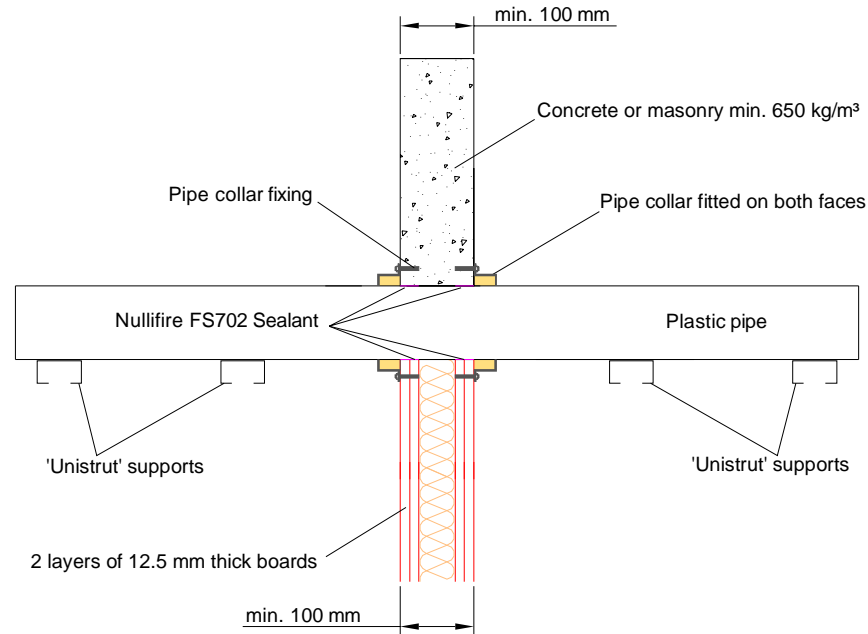

APPROVAL:

ETA 17/0136

Tested pipe types and max. Ø of the pipes
 Look at the table in this detail

Nullifire FP170-PS7
 Fire class; Look at the table in this detail

Additional information ETA-approval/ Annex A.

Technical installation instructions need to be followed installing the products.

Services: PP -pipe

PP pipe according to EN ISO 15494

U/C = (Uncapped/Capped)

Services	Collar Inlay	Fire class
PP -pipe Ø40 mm / 2.0 mm wall	30 x 6 mm	EH120: U/U, C/U, U/C, C/C
PP -pipe Ø40 mm / 2.1-4.3 mm wall		E160: U/U, C/U, U/C, C/C
PP -pipe Ø50 mm / 2.0 mm wall		EH120: U/U, C/U, U/C, C/C
PP -pipe Ø50 mm / 2.1-4.3 mm wall		E160: U/U, C/U, U/C, C/C
PP -pipe Ø75 mm / 2.0 mm wall		EH120: U/U, C/U, U/C, C/C
PP -pipe Ø75 mm / 2.1-4.3 mm wall		E160: U/U, C/U, U/C, C/C
PP -pipe Ø80 mm / 2.0 mm wall		EH120: U/U, C/U, U/C, C/C
PP -pipe Ø80 mm / 2.1-4.3 mm wall		E160: U/U, C/U, U/C, C/C
PP -pipe Ø90 mm / 2.7 mm wall	30 x 10 mm	EH120: U/U, C/U, U/C, C/C
PP -pipe Ø110 mm / 2.7 mm wall		

THE CONTENTS OF THE DRAWING

PP -pipe penetrating through a flexible or rigid wall construction with FP170 pipe collar

DESIGNER

REV

Nullifire has provided this specification on the basis of the data and information given to Nullifire by the customer, the Nullifire product information and level of technical knowledge this specification relates to is expected to provide the level of fire performance, should the proposed detail be subjected to the standardised fire resistance performance against which the judgment has been made.

The accuracy of this specification relies on the following:
 1. Only Nullifire products as defined in the specification are used.
 2. The specific products are installed by a competent person, utilising Nullifire installation manual and data sheets noting limitations.
 3. The proposed specification has been checked by the user.
 4. For Details on CE Marked Products Refer to the CE Technical Data Sheets.

SEAL OF APPROVAL MUST BE VERIFIED IF THIS DOCUMENT HAS BEEN MODIFIED

DATE

11.10.2018

SCALE

Not scaled

DETAIL MARK

FP170-PS7

Nullifire

**Nullifire
FP170-PS8**
**Flexible or rigid wall thickness of
min. 100mm or 130mm**

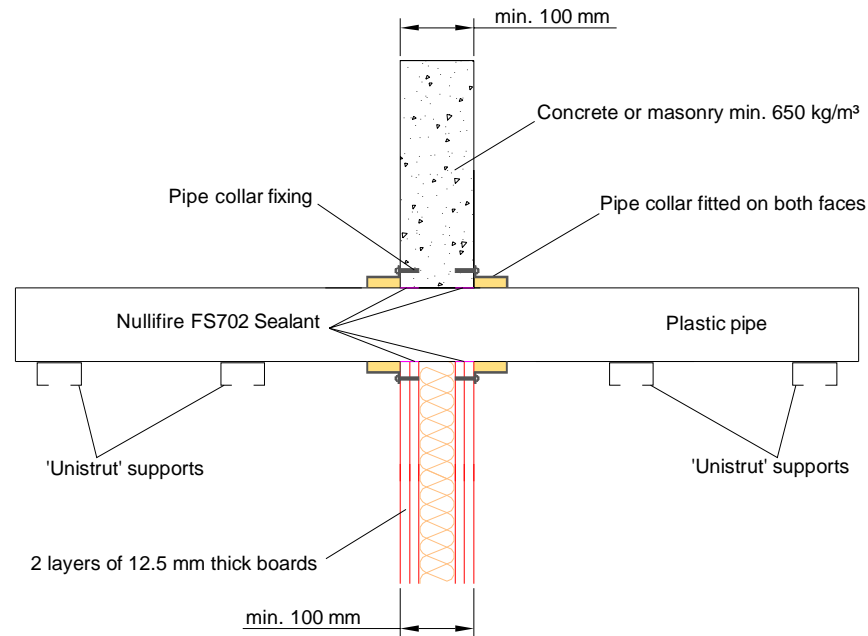

APPROVAL:

ETA 17/0136

**Tested pipe types and max.
Ø of the pipes**
Look at the table in this detail

Nullifire FP170-PS8
**Fire class; Look at the table
in this detail**

Additional information ETA-
approval/ Annex A.

Technical installation
instructions need to be followed
installing the products.

Services: PP -pipe

PP pipe according to EN ISO
15494

U/C = (Uncapped/Capped)

Services	Collar Inlay	Fire class
PP-pipe Ø140 mm / 3.5 mm wall	45 x 16 mm	EI45: U/U, C/U, U/C, C/C
PP-pipe Ø140 mm / 4.0^ mm wall		EI120: U/U, C/U, U/C, C/C
PP-pipe Ø160 mm / 4.0^ mm wall		
PP-pipe Ø140 mm / 4.0-14.6 mm^ wall		EI45: U/U, C/U, U/C, C/C
PP-pipe Ø160 mm / 4.0-14.6 mm^ wall		

^only 130mm wall

THE CONTENTS OF THE DRAWING

**PP -pipe penetrating through a flexible or rigid wall
construction with FP170 pipe collar**

DESIGNER

REV

DATE

11.10.2018

SCALE

Not scaled

DETAIL MARK

FP170-PS8

Nullifire has provided this specification on the basis of the data and information given to Nullifire by the customer, the Nullifire product information and level of technical knowledge this specification relates to is expected to provide the level of fire performance, should the proposed detail be subjected to the standardised fire resistance performance against which the judgment has been made.

The accuracy of this specification relies on the following:
1. Only Nullifire products as defined in the specification are used.
2. The specific products are installed by a competent person, utilising Nullifire installation manual and data sheets noting limitations.
3. The proposed specification has been checked by the user.
4. For Details on CE Marked Products Refer to the CE Technical Data Sheets.

SEAL OF APPROVAL MUST BE VERIFIED IF THIS DOCUMENT HAS BEEN MODIFIED

Nullifire

Nullifire
FP170-PS9
Rigid wall thickness of min. 100mm

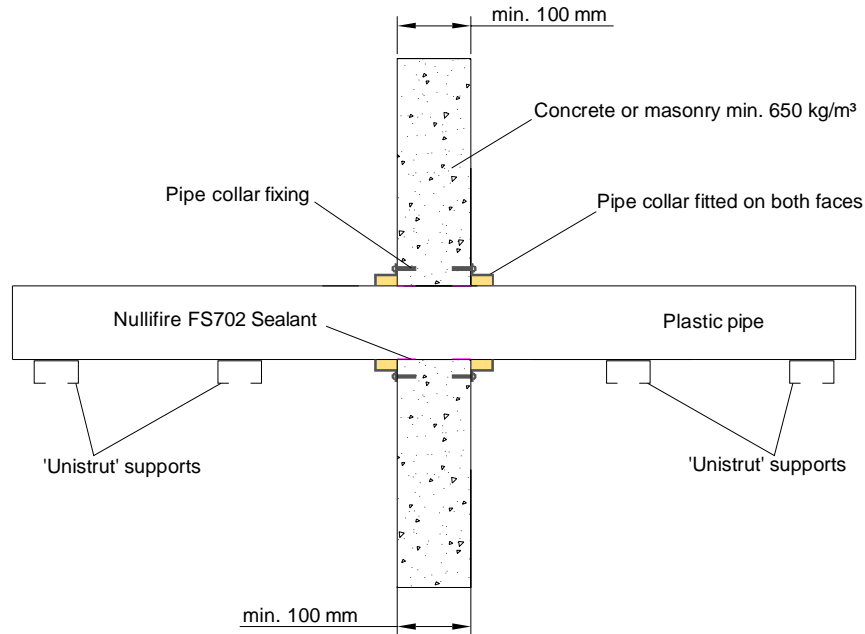

APPROVAL:

ETA 17/0136

Tested pipe types and max. Ø of the pipes
 Look at the table in this detail

Nullifire FP170-PS9
 Fire class; Look at the table in this detail

Additional information ETA-approval/ Annex A.

Technical installation instructions need to be followed installing the products.

* PVC-U pipe according to EN 1329-1, EN 1452-2 and EN 1453-1

U/C = (Uncapped/Capped)

Services	Collar Inlay	Fire class
PVC-U* Ø90 mm / 1.8-4.2 mm wall	30 x 10 mm	EI240: U/U, C/U, U/C, C/C
PVC-U* Ø110 mm / 1.8-4.2 mm wall		
PVC-U* Ø125 mm / 2.5 mm wall	45 x 16 mm	
PVC-U* Ø140 mm / 2.5 mm wall		
PVC-U* Ø160 mm / 2.5 mm wall		

THE CONTENTS OF THE DRAWING

Plastic pipe penetrating through rigid wall construction with FP170 pipe collar

DESIGNER

REV

DATE

11.10.2018

SCALE

Not scaled

DETAIL MARK

FP170-PS9

Nullifire has provided this specification on the basis of the data and information given to Nullifire by the customer, the Nullifire product information and level of technical knowledge this specification relates to is expected to provide the level of fire performance, should the proposed detail be subjected to the standardised fire resistance performance against which the judgment has been made.

The accuracy of this specification relies on the following:
 1. Only Nullifire products as defined in the specification are used.
 2. The specific products are installed by a competent person, utilising Nullifire installation manual and data sheets noting limitations.
 3. The proposed specification has been checked by the user.
 4. For Details on CE Marked Products Refer to the CE Technical Data Sheets.

SEAL OF APPROVAL MUST BE VERIFIED IF THIS DOCUMENT HAS BEEN MODIFIED

Nullifire

Nullifire
FP170-PS10
Rigid wall thickness of min. 100mm

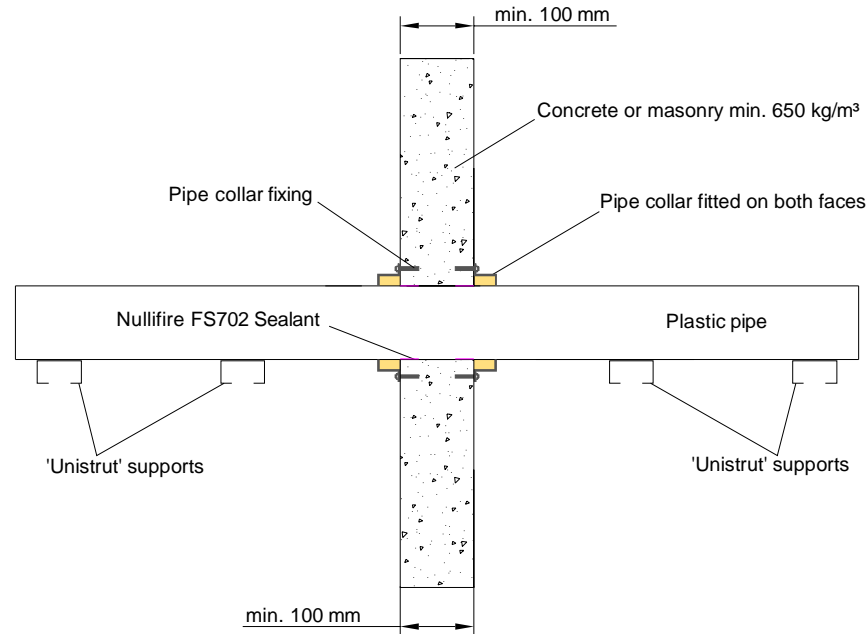

APPROVAL:

ETA 17/0136

Tested pipe types and max. Ø of the pipes
 Look at the table in this detail

Nullifire FP170-PS10
 Fire class; Look at the table in this detail

Additional information ETA-approval/ Annex A.

Technical installation instructions need to be followed installing the products.

Services: PE, ABS and SAN+PVC

PE pipe according to EN 1519-1, EN 12201-2 and EN 1266-1,

ABS pipe according to EN 1455-1

SAN+PVC pipe according to EN 1565-1

U/C = (Uncapped/Capped)

Services	Collar Inlay	Fire class
PIPE Ø125 mm / 6.2 mm wall	45 x 16 mm	EI240: U/U, C/U, U/C, C/C
PIPE Ø140 mm / 6.2 mm wall		
PIPE Ø160 mm / 6.2 mm wall		

THE CONTENTS OF THE DRAWING

Plastic pipes penetrating through rigid wall construction with FP170 pipe collar

DESIGNER

REV

DATE

11.10.2018

SCALE

Not scaled

DETAIL MARK

FP170-PS10

Nullifire has provided this specification on the basis of the data and information given to Nullifire by the customer, the Nullifire product information and level of technical knowledge this specification relates to is expected to provide the level of fire performance, should the proposed detail be subjected to the standardised fire resistance performance against which the judgment has been made.

The accuracy of this specification relies on the following:
 1. Only Nullifire products as defined in the specification are used.
 2. The specific products are installed by a competent person, utilising Nullifire installation manual and data sheets noting limitations.
 3. The proposed specification has been checked by the user.
 4. For Details on CE Marked Products Refer to the CE Technical Data Sheets.

SEAL OF APPROVAL MUST BE VERIFIED IF THIS DOCUMENT HAS BEEN MODIFIED

Nullifire

Nullifire
FP170-PS11
Rigid wall thickness of min. 100mm

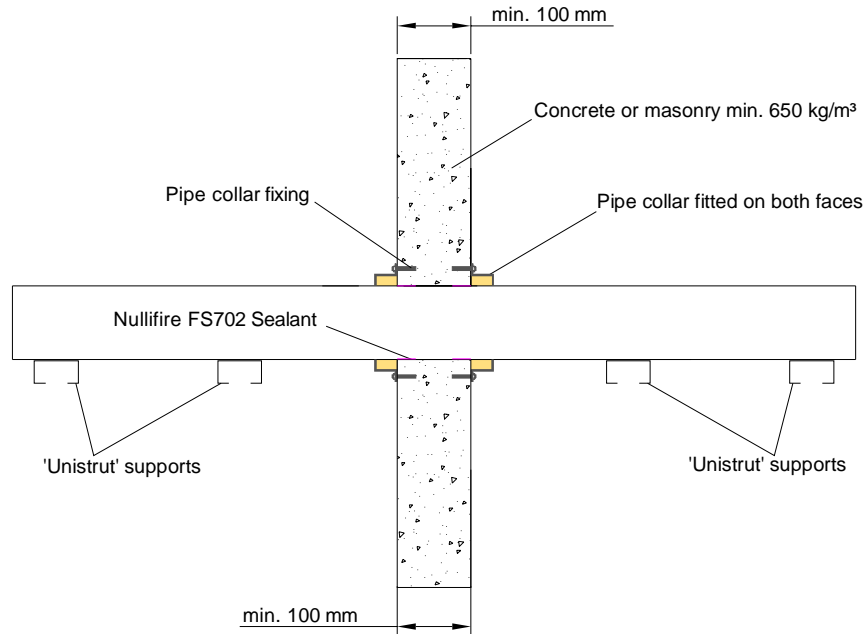

APPROVAL:

ETA 17/0136

Tested pipe types and max. Ø of the pipes
 Look at the table in this detail

Nullifire FP170-PS11
 Fire class; Look at the table in this detail

Additional information ETA-approval/ Annex A.

Technical installation instructions need to be followed installing the products.

Services: BevEx Drinks Python

U/C = (Uncapped/Capped)

Services	Collar Inlay	Fire class
BevEx Drinks Python Ø80 mm	30 x 6 mm	EI240: U/U, C/U, U/C, C/C

THE CONTENTS OF THE DRAWING

BevEx Drinks Python penetrating through a rigid wall construction with FP170 pipe collar

DESIGNER

REV

DATE

11.10.2018

SCALE

Not scaled

DETAIL MARK

FP170-PS11

Nullifire has provided this specification on the basis of the data and information given to Nullifire by the customer, the Nullifire product information and level of technical knowledge this specification relates to is expected to provide the level of fire performance, should the proposed detail be subjected to the standardised fire resistance performance against which the judgment has been made.

The accuracy of this specification relies on the following:
 1. Only Nullifire products as defined in the specification are used.
 2. The specific products are installed by a competent person, utilising Nullifire installation manual and data sheets noting limitations.
 3. The proposed specification has been checked by the user.
 4. For Details on CE Marked Products Refer to the CE Technical Data Sheets.

SEAL OF APPROVAL MUST BE VERIFIED IF THIS DOCUMENT HAS BEEN MODIFIED

Nullifire

Nullifire
FP170-PS12
Rigid wall thickness of min. 100mm

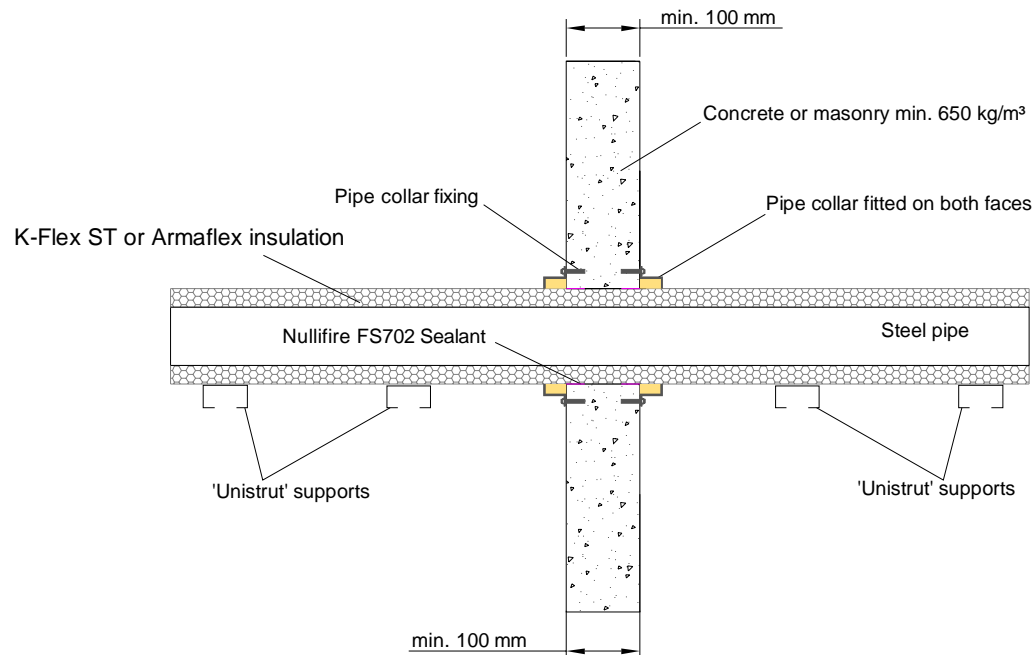

APPROVAL:

ETA 17/0136

Tested pipe types and max. Ø of the pipes
 Look at the table in this detail

Nullifire FP170-PS12
 Fire class; Look at the table in this detail

Additional information ETA-approval/ Annex A.

Technical installation instructions need to be followed installing the products.

Steel pipe with Continuous Sustained K-Flex ST or Armaflex insulation

U/C = (Uncapped/Capped)

Services	Collar Inlay	Fire class
Steel pipe Ø47.6 mm / 1.5 - 14.2 mm wall 13 mm insulation	30 x 6 mm	E180: C/C
Steel pipe Ø114.3 mm / 2 - 14.2 mm wall 19 mm insulation	45 x 16 mm	E120: C/C

THE CONTENTS OF THE DRAWING

Steel pipe penetrating through a rigid wall construction with FP170 pipe collar

DESIGNER

REV

DATE

11.10.2018

SCALE

Not scaled

DETAIL MARK

FP170-PS12

Nullifire has provided this specification on the basis of the data and information given to Nullifire by the customer, the Nullifire product information and level of technical knowledge this specification relates to is expected to provide the level of fire performance, should the proposed detail be subjected to the standardised fire resistance performance against which the judgment has been made.

- The accuracy of this specification relies on the following:
1. Only Nullifire products as defined in the specification are used.
 2. The specific products are installed by a competent person, utilising Nullifire installation manual and data sheets noting limitations.
 3. The proposed specification has been checked by the user.
 4. For Details on CE Marked Products Refer to the CE Technical Data Sheets.

SEAL OF APPROVAL MUST BE VERIFIED IF THIS DOCUMENT HAS BEEN MODIFIED

Nullifire

Nullifire
FP170-PS13
Flexible or rigid wall thickness of
min. 100mm

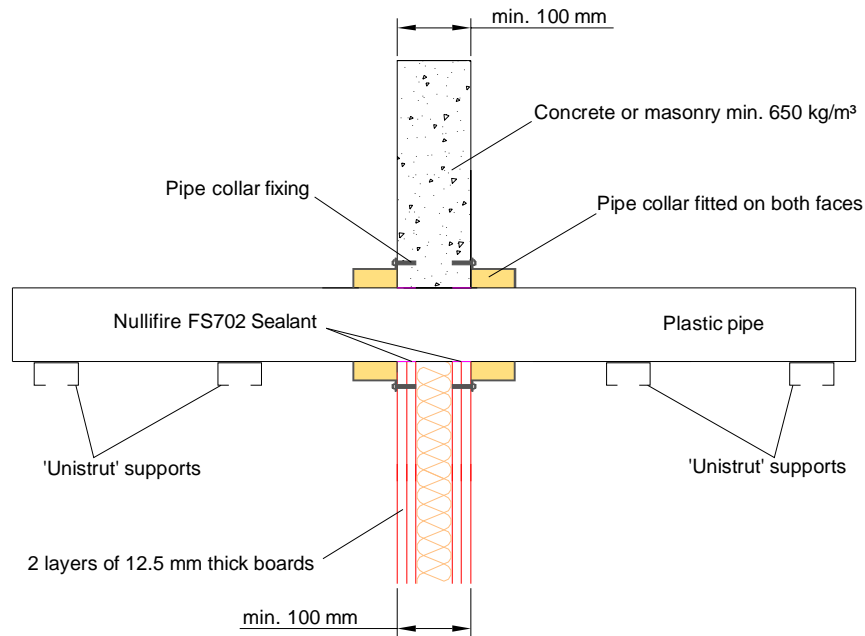

APPROVAL:

ETA 17/0136

Tested pipe types and max. Ø of the pipes
 Look at the table in this detail

Nullifire FP170-PS13
 Fire class; Look at the table in this detail

Additional information ETA-approval/ Annex A.

Technical installation instructions need to be followed installing the products.

* PVC-U pipe according to EN 1329-1, EN 1452-2 and EN 1453-1

U/C = (Uncapped/Capped)

Services	Collar Inlay	Fire class
PVC-U* Ø200 mm / 10.6 mm wall	60 x 26 mm	EI90: U/U, C/U, U/C, C/C
PVC-U* Ø225 mm / 10.6 mm wall		
PVC-U* Ø250 mm / 10.6 mm wall		

THE CONTENTS OF THE DRAWING

PVC-U pipe penetrating through a flexible or rigid wall construction with FP170 pipe collar

DESIGNER

REV

DATE

11.10.2018

SCALE

Not scaled

DETAIL MARK

FP170-PS13

Nullifire has provided this specification on the basis of the data and information given to Nullifire by the customer, the Nullifire product information and level of technical knowledge this specification relates to is expected to provide the level of fire performance, should the proposed detail be subjected to the standardised fire resistance performance against which the judgment has been made.

The accuracy of this specification relies on the following:
 1. Only Nullifire products as defined in the specification are used.
 2. The specific products are installed by a competent person, utilising Nullifire installation manual and data sheets noting limitations.
 3. The proposed specification has been checked by the user.
 4. For Details on CE Marked Products Refer to the CE Technical Data Sheets.

SEAL OF APPROVAL MUST BE VERIFIED IF THIS DOCUMENT HAS BEEN MODIFIED

Nullifire

Nullifire
FP170-PS14
Rigid wall thickness of min. 100mm

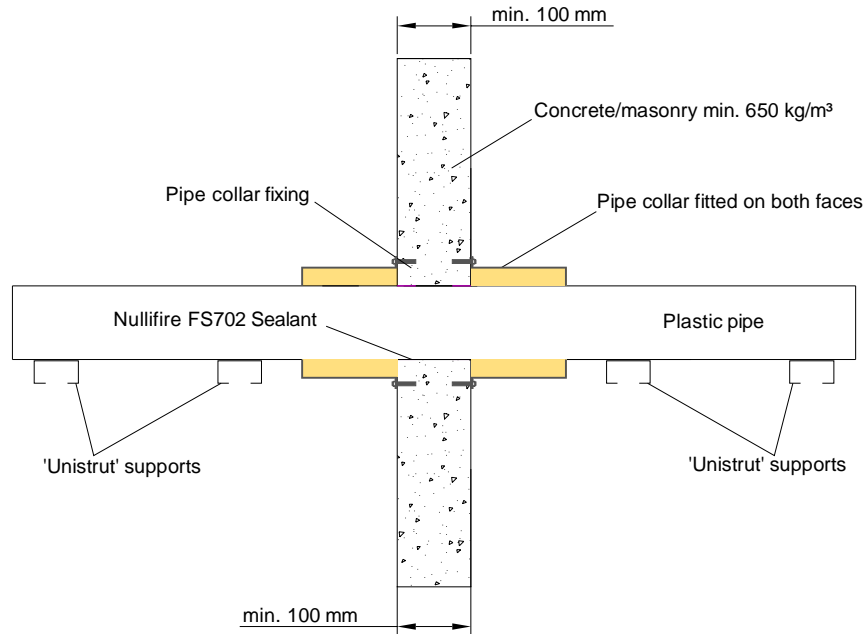

APPROVAL:

ETA 17/0136

Tested pipe types and max. Ø of the pipes
 Look at the table in this detail

Nullifire FP170-PS14
 Fire class; Look at the table in this detail

Additional information ETA-approval/ Annex A.

Technical installation instructions need to be followed installing the products.

Services: PVC-U pipe

PVC-U pipe according to EN 1329-1, EN 1452-2 and EN 1453-1

U/C = (Uncapped/Capped)

Services	Collar Inlay	Fire class
PIPE Ø200 mm / 10.6 mm wall	130 x 24 mm	EI240: U/U, C/U, U/C, C/C
PIPE Ø225 mm / 10.6 mm wall		
PIPE Ø250 mm / 10.6 mm wall		
PIPE Ø315 mm / 12.1 mm wall	130 x 32 mm	EI120: U/U, C/U, U/C, C/C

THE CONTENTS OF THE DRAWING

Plastic pipe penetrating through a rigid wall construction with FP170 pipe collar

DESIGNER

REV

DATE

11.10.2018

SCALE

Not scaled

DETAIL MARK

FP170-PS14

Nullifire has provided this specification on the basis of the data and information given to Nullifire by the customer, the Nullifire product information and level of technical knowledge this specification relates to is expected to provide the level of fire performance, should the proposed detail be subjected to the standardised fire resistance performance against which the judgment has been made.

- The accuracy of this specification relies on the following:
1. Only Nullifire products as defined in the specification are used.
 2. The specific products are installed by a competent person, utilising Nullifire installation manual and data sheets noting limitations.
 3. The proposed specification has been checked by the user.
 4. For Details on CE Marked Products Refer to the CE Technical Data Sheets.

SEAL OF APPROVAL MUST BE VERIFIED IF THIS DOCUMENT HAS BEEN MODIFIED

Nullifire

Nullifire
FP170-PS15
Rigid wall thickness of min. 100mm

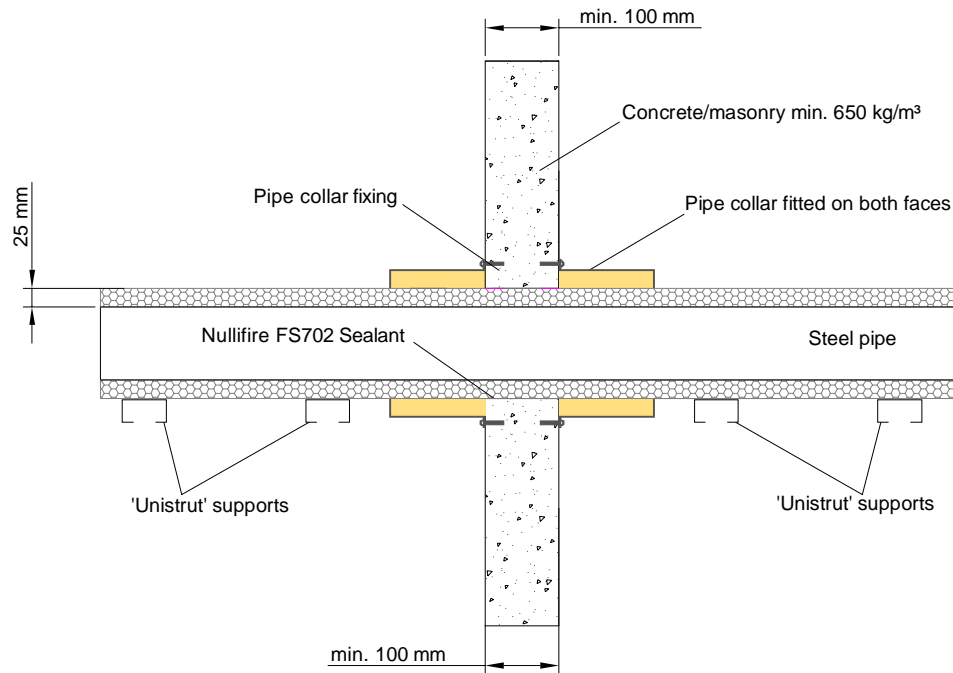

APPROVAL:

ETA 17/0136

Tested pipe types and max. Ø of the pipes
 Look at the table in this detail

Nullifire FP170-PS15
 Fire class; Look at the table in this detail

Additional information ETA-approval/ Annex A.

Technical installation instructions need to be followed installing the products.

Services: Steel pipe

Steel pipe, with Continuous Sustained K-Flex ST or Armaflex insulation 25 mm

U/C = (Uncapped/Capped)

Services	Collar Inlay	Fire class
PIPE Ø219.1 mm / 6.4 - 14.2 mm wall	130 x 32 mm	E190: C/C

THE CONTENTS OF THE DRAWING

Steel pipe penetrating through a rigid wall construction with FP170 pipe collar

DESIGNER

REV

DATE

11.10.2018

SCALE

Not scaled

DETAIL MARK

FP170-PS15

Nullifire has provided this specification on the basis of the data and information given to Nullifire by the customer, the Nullifire product information and level of technical knowledge this specification relates to is expected to provide the level of fire performance, should the proposed detail be subjected to the standardised fire resistance performance against which the judgment has been made.

The accuracy of this specification relies on the following:
 1. Only Nullifire products as defined in the specification are used.
 2. The specific products are installed by a competent person, utilising Nullifire installation manual and data sheets noting limitations.
 3. The proposed specification has been checked by the user.
 4. For Details on CE Marked Products Refer to the CE Technical Data Sheets.

SEAL OF APPROVAL MUST BE VERIFIED IF THIS DOCUMENT HAS BEEN MODIFIED

Nullifire